

HYPERBOLIC FUNNEL

Competition for Outdoor Art Work in Public Areas in Vogabyggð
2018

HYPERBOLIC FUNNEL

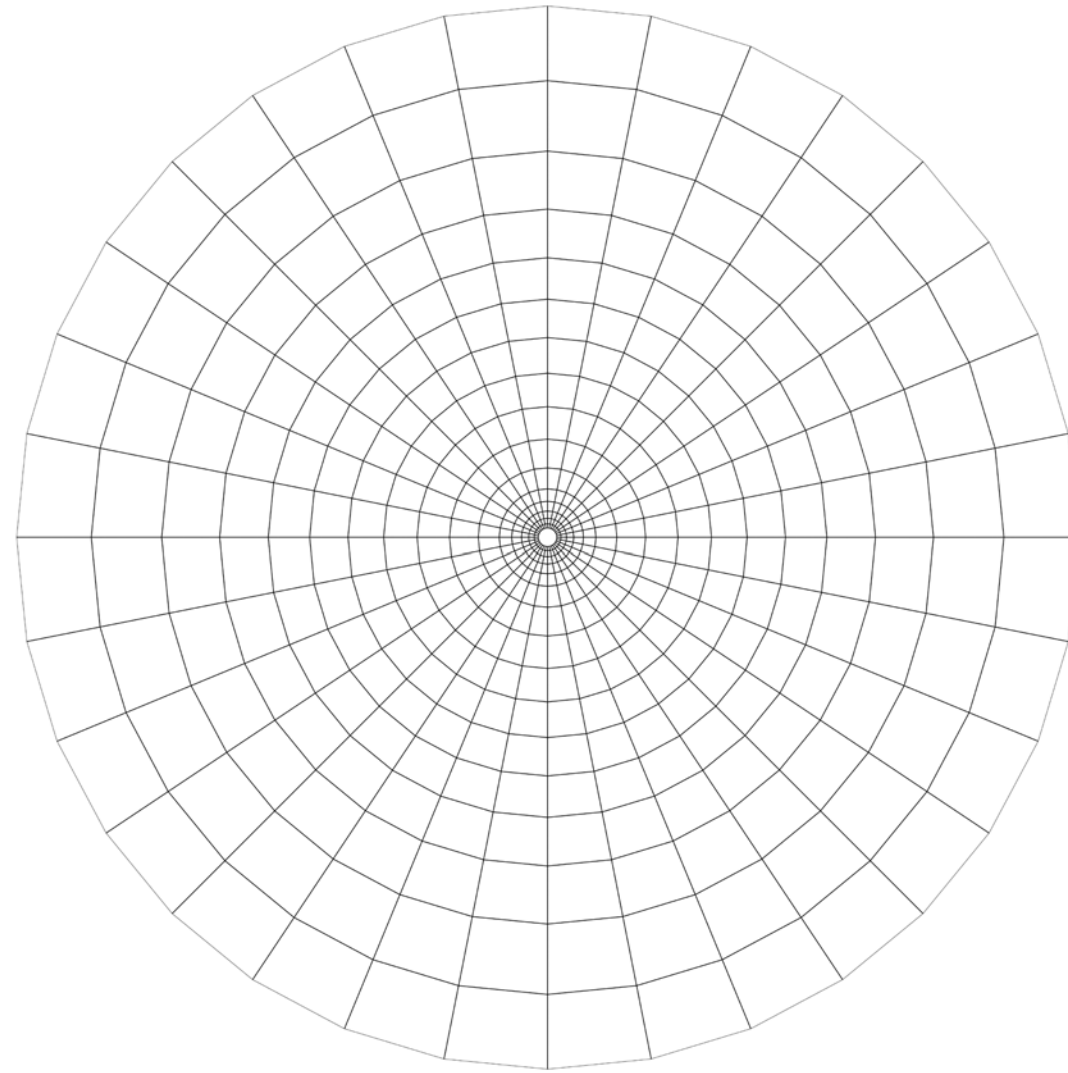

Diameter : 10 m

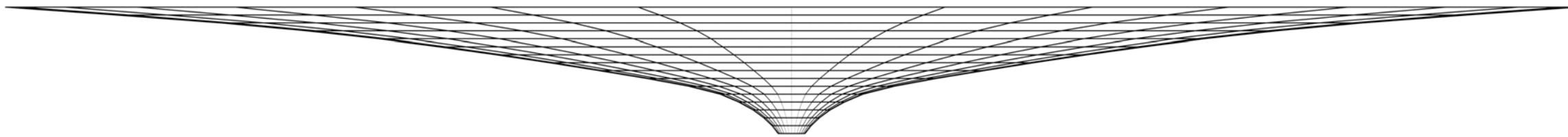

Middle depth: 1 m
Center is closed

Reference number:

VERSION (A)



Soft concrete surface
in cobblestone landscape



Soft concrete surface
in grass landscape

Reference number:

VERSION (A)

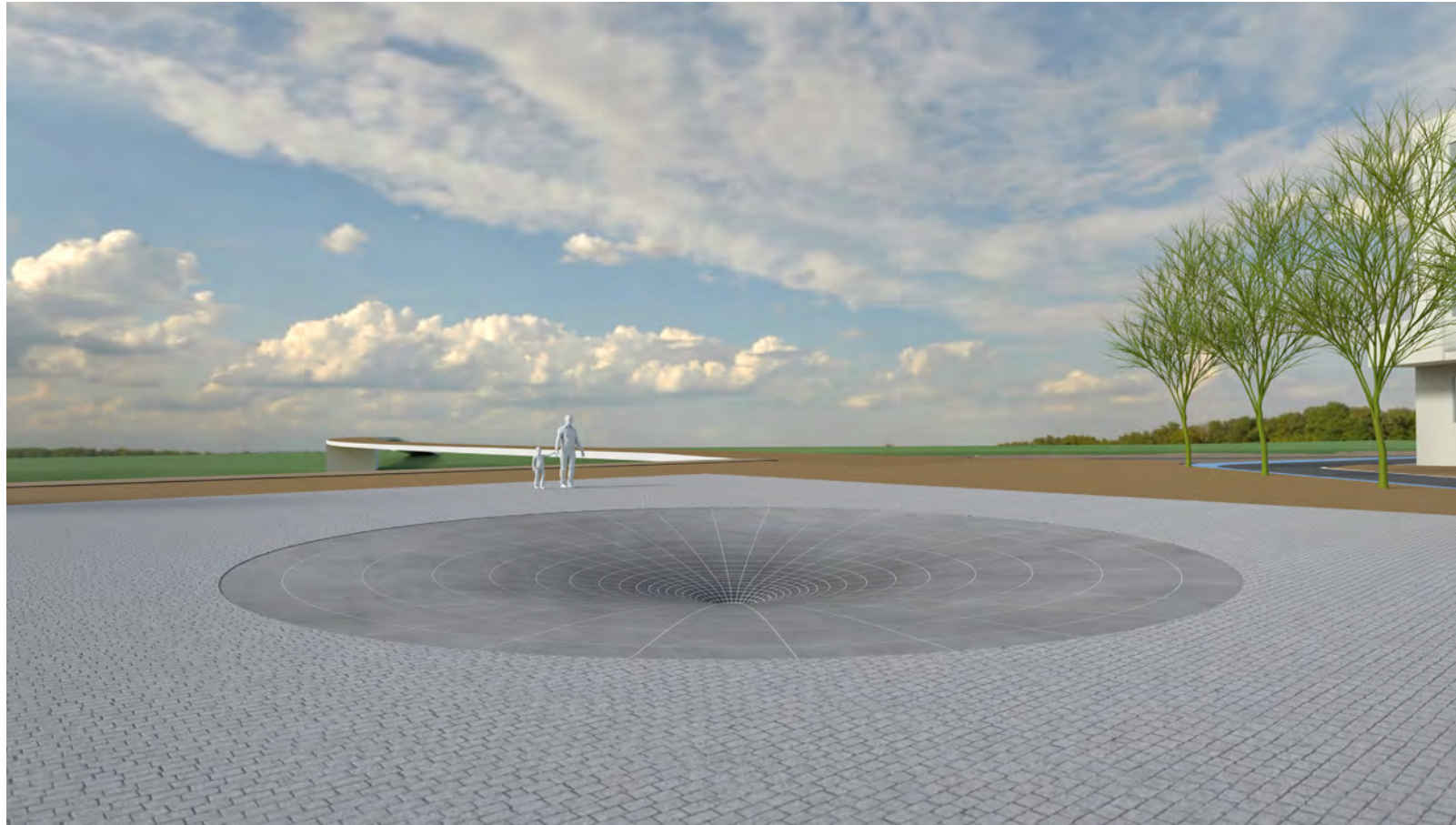

Soft concrete surface
with embedded aluminum profiles
in cobblestone landscape



Soft concrete surface
with embedded aluminum profiles
in grass landscape

Reference number:

VERSION (B)



Black terrazzo surface
in cobblestone landscape

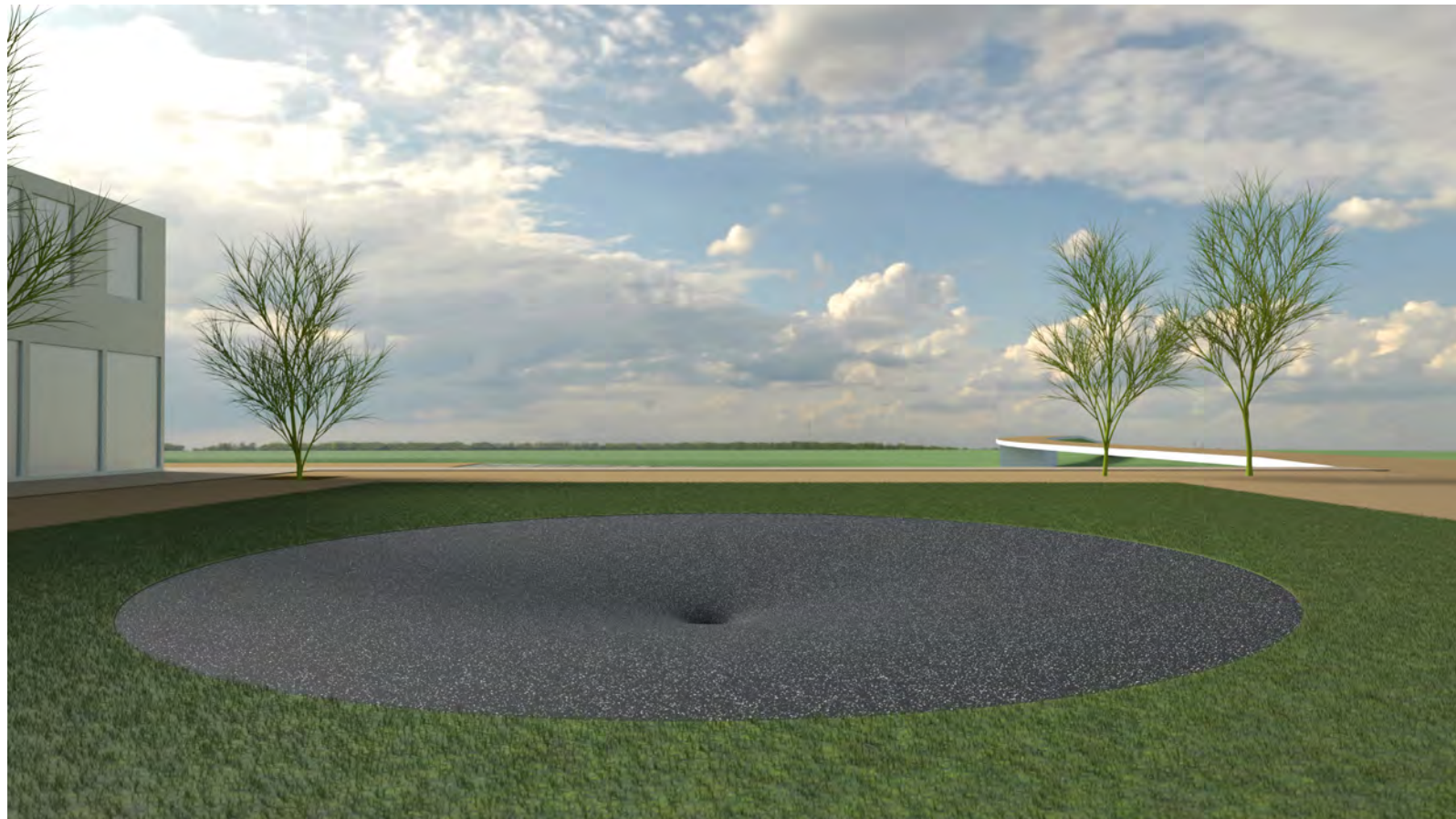

Black terrazzo surface
in grass landscape

Reference number:

VERSION (B)



Black terrazzo surface
with embedded aluminum profiles
in cobblestone landscape



Black terrazzo surface
with embedded aluminum profiles
in grass landscape

Reference number:

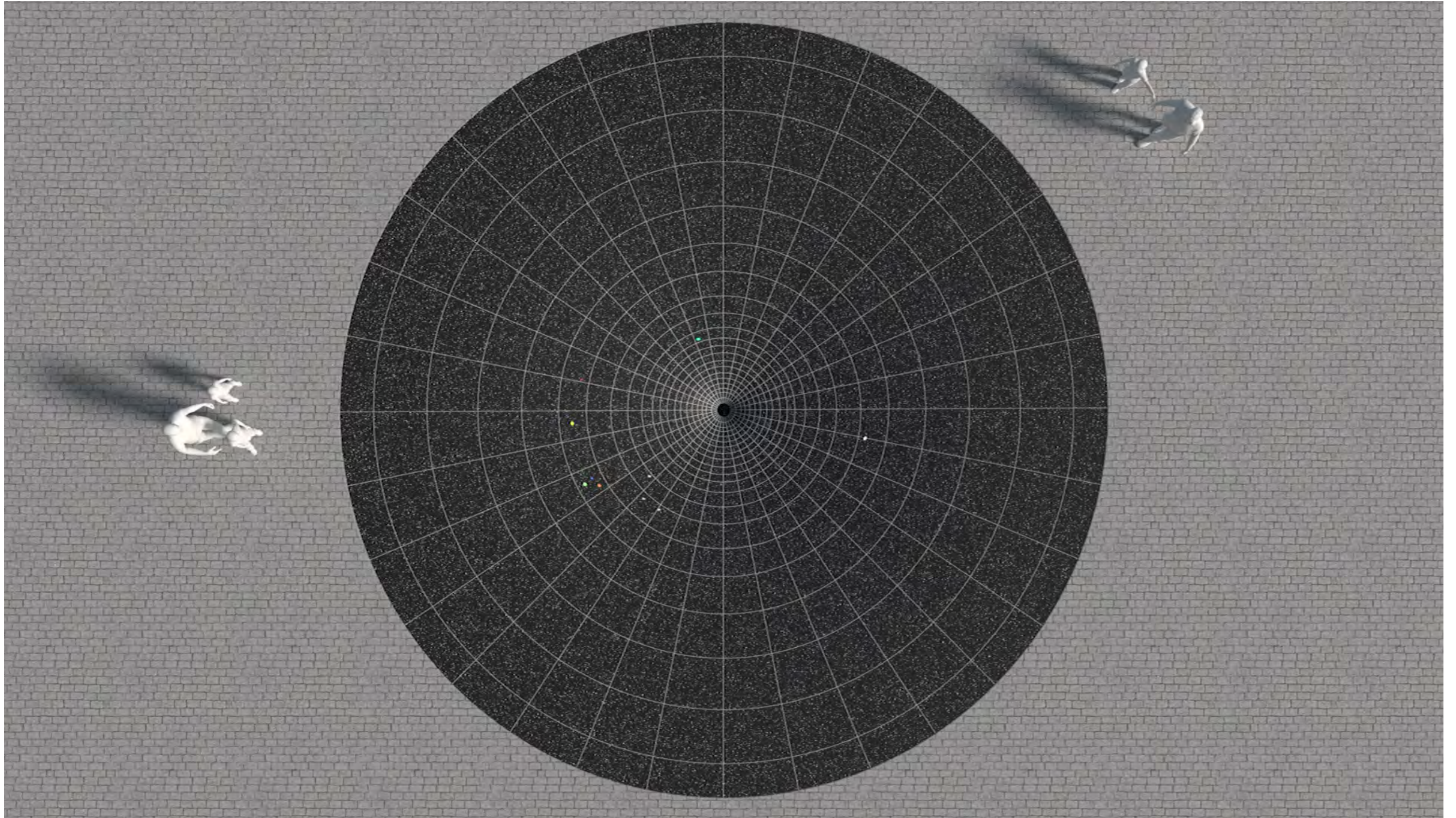

SURFACE OPTIONS



VERSION (A)
Soft concrete surface



VERSION (A)
Soft concrete surface with embedded aluminum profiles



VERSION (B)
Black terrazzo surface

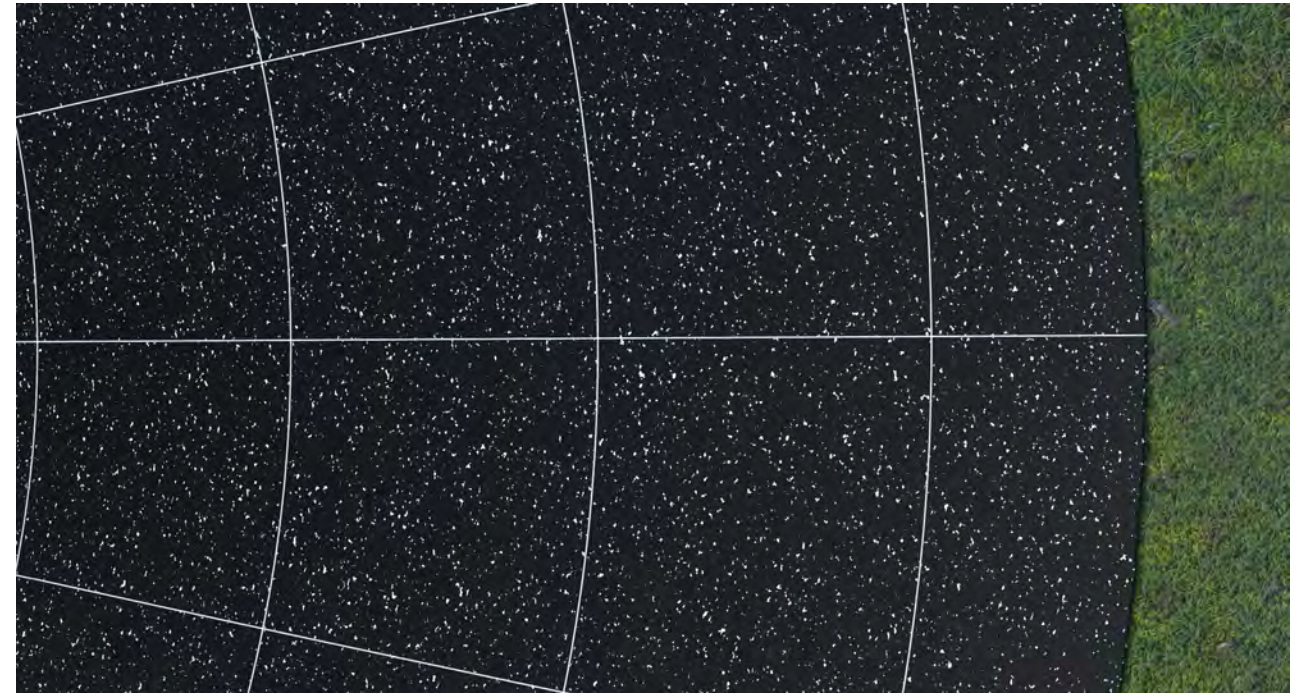

VERSION (B)
Black terrazzo surface with embedded aluminum profiles

Reference number:

HYPERBOLIC FUNNEL

The hyperbolic funnel is a working model of the solar system that displays Johannes Kepler's laws of planetary motion. The sculpture is inserted into a public landscape and allows interaction with gravitational force, the natural phenomenon by which all things with mass or energy - including planets, stars, galaxies, and even light - are brought toward one another. When a passerby launches a marble into the funnel, friction removes energy of the rolling marble, causing it to drop down into the well. The potential energy of each marble is converted into kinetic energy so that as the marble drops down it has a higher velocity, similar to how the planets closer to the sun orbit faster around it than the planets in further distance.

The sculpture and its environment becomes a reminder of our perception of the flow of time, but time not as a river that flows, but as a space - a landscape - static and laid out around us in its entirety. While our march across the landscape of time is relentless, the landscape itself is filled with great potential, which lies dormant, waiting only to be triggered by our actions. In Einstein's theory of relativity, point of view plays an important role: time is not objective but relative to the place from which events are observed. If it is relative under the laws of physical space then it may also be relative within the 'space' of an individual's time: i.e. relative to the point of view as perceived by a person from a given instance. The sculpture points to a somewhat vertical time, as Maurice Nicoll describes in his book **Living Time**: *"all insight, all revelation, all illumination, all love, all that is genuine, all that is real, lies in now - and in the attempt to create now we approach the inner precincts, the holiest part of life. For in time all things are seeking completion, but in now all things are complete."*

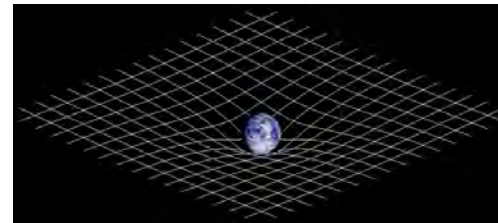
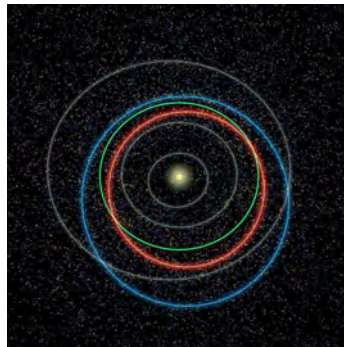

Reference number:

DESCRIPTION & MATERIAL

The sculpture is 10 meters in diameter and drops down 1 meter at the center of the funnel. The center of the funnel is closed, which makes it easy for people to collect their marbles or whatever other sphere shaped objects they chose to spin on the surface of the sculpture. The concrete structure is inserted into the ground at level with the surrounding landscape. The sculpture is heated to prevent a slippery surface during wet weather situations. Two surface materials are being proposed; one is a soft concrete surface and the other is a polished black terrazzo surface, both with options of inserted aluminum profiles to underline the curvature of the shape. The dimensions as well as the placement within the Vogabyggð area is very flexible.

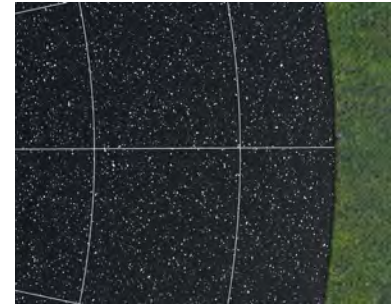
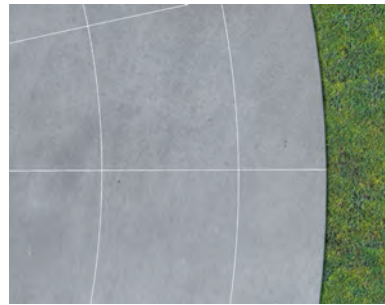
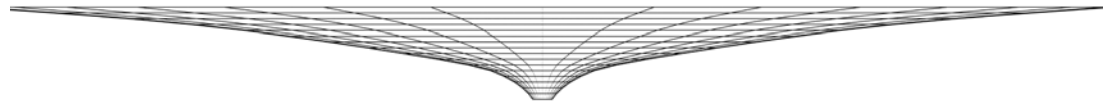
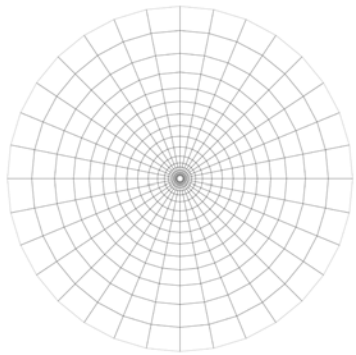

Reference number: